

# FICHE TECHNIQUE

## CHAPE SUPPORT DE GALETS

Groupe  
**06-01-03-01**



Données client

Type machine : ..... Demande de prix  
 No. série machine : ..... Commande

CODE : TY x L x B x H x D1 x D2 x C x D3 x TA x Pm x Pi x RH/LH x S x AT-BU x AFW x SMP



- TY..... Type A ou B (voir fig.).
- L..... Longueur totale (mm).
- B..... Largeur max., voir fig. (mm).
- H..... Hauteur max., voir fig. (mm).
- D1 ..... Diamètre, voir fig. (mm).
- D2 ..... Diamètre, voir fig. (mm).
- C..... Entraxe, voir fig (mm).
- D3 ..... Diamètre, voir fig. (plat ou conique).
- TA ..... Filetage.
- Pm..... Pas (métrique).
- Pi ..... Pas (pouce).
- RH/LH..... Droite ou gauche.
- S..... Dimension, voir fig. (mm).
- AT-BU..... Quantité de bagues.
- AFW ..... Finition :
  - A = métal
  - B = couleur
  - C = zinguée par électrolyse couleur argent
  - D = zinguée par électrolyse couleur or
  - E = galvanisée
  - F = inox
  - G = aluminium
  - H = coldstore
- SMP..... Graisseur : OUI/NON.

# TYPES

## Type A

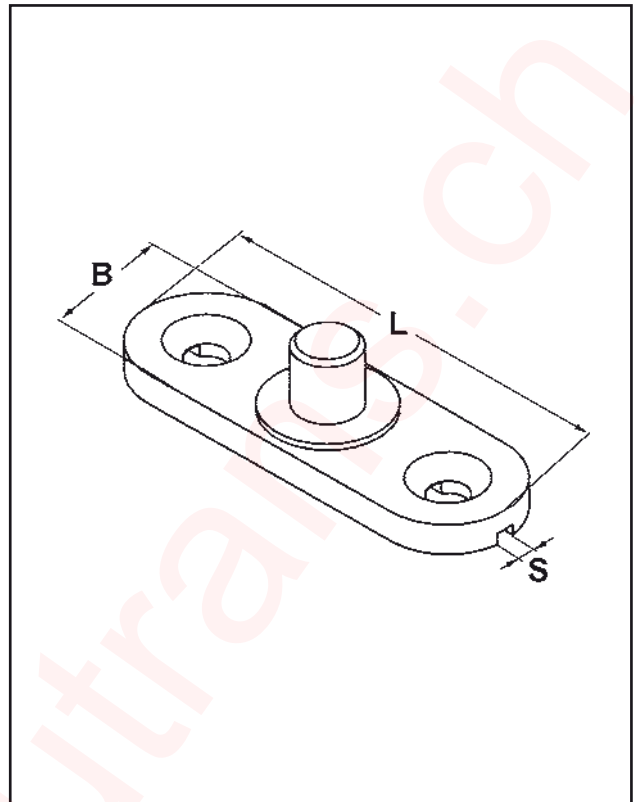
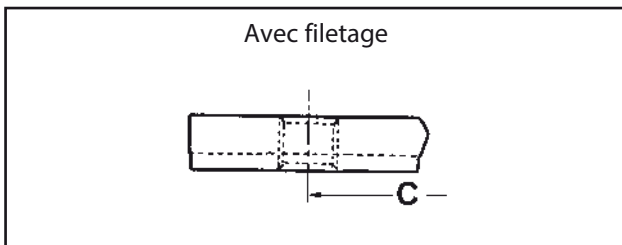
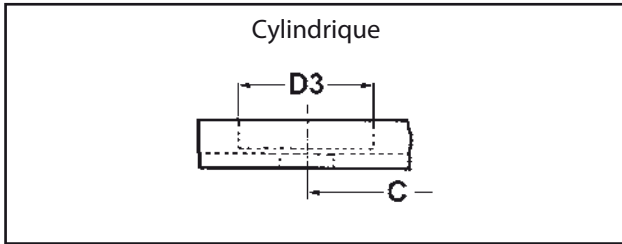
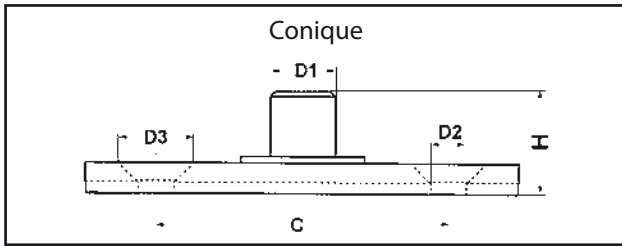

## Type B Étrier

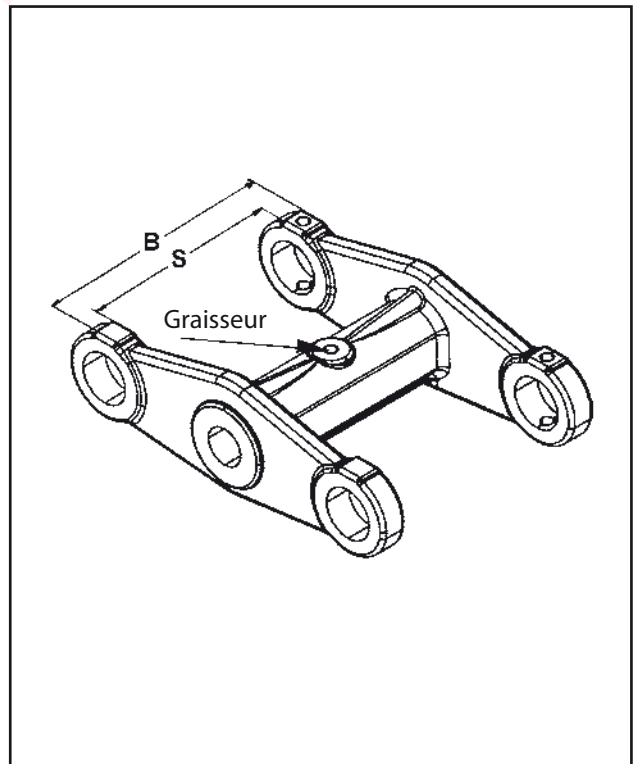
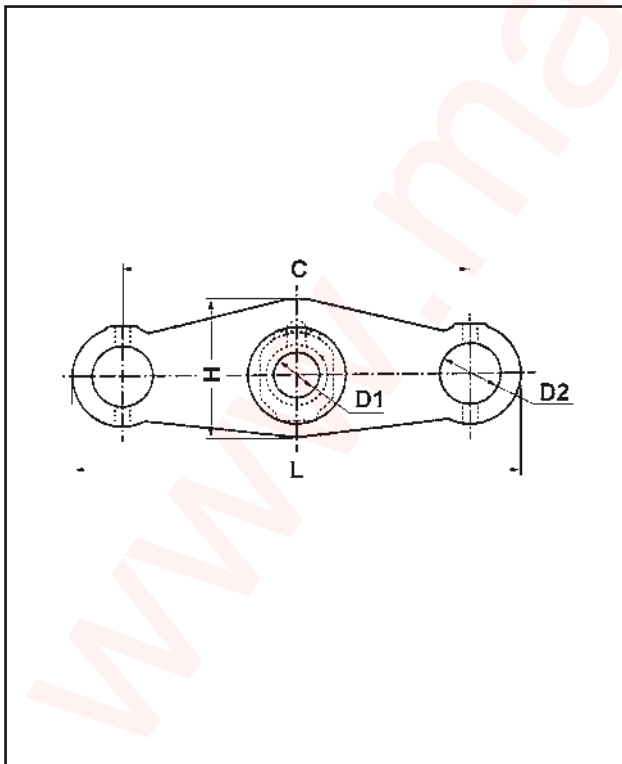

# TECHNICAL SHEET

## WHEEL HOLDER

Group  
**06-01-03-01**

Example

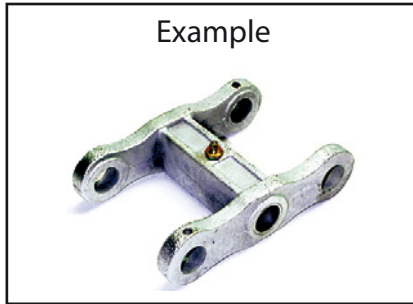

Customer details

Type machine: .....

Price inquiry

Serial n° machine: .....

Order

CODE: TY x L x B x H x D1 x D2 x C x D3 x TA x Pm x Pi x RH/LH x S x AT-BU x AFW x SMP

TY..... Type (as per picture).  
 L..... Max. length, as per picture (mm).  
 B..... Max. width, as per picture (mm).  
 H..... Max. height, as per picture (mm).  
 D1 ..... Type A: pin or hole, type B: centre hole (as per picture).  
 D2 ..... Diameter pin hole (mm).  
 C..... Distance, as per picture (mm).  
 D3 ..... Diameter chamber (straight or tapered).  
 TA ..... Thread type (if threaded).  
 Pm..... Pitch (metric) of thread.  
 Pi ..... Pitch (inch) of thread.  
 RH/LH..... Left- or right-hand thread.  
 S..... Distance, as per picture (mm).  
 AT-BU..... Quantity of bushes (if fitted!).  
 AFW ..... Coating:  
     *A = none*  
     *B = paint*  
     *C = zink coated by electrolysis silver coloured*  
     *D = zink coated by electrolysis gold coloured*  
     *E = galvanised*  
     *F = stainless steel*  
     *G = aluminium*  
     *H = coldstore*  
 SMP..... Grease nipple: YES/NO.

# TYPES

## Type A

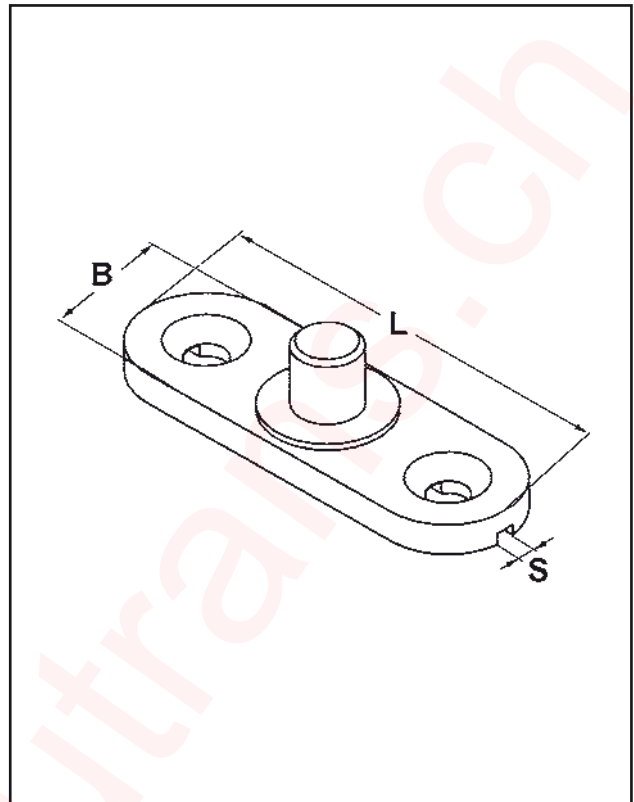
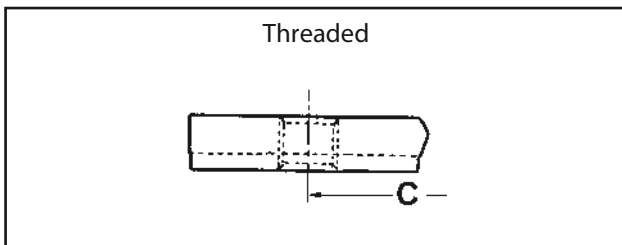
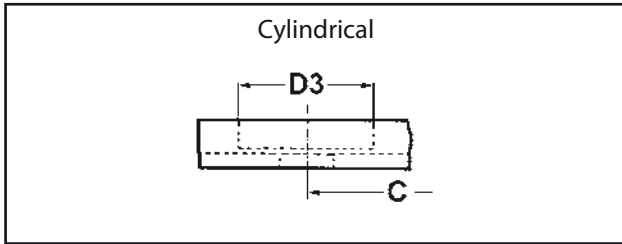
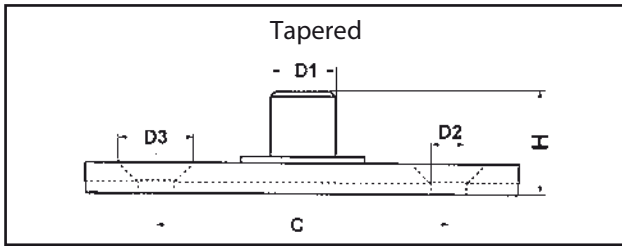

## Type B

Wheel holder (complete)

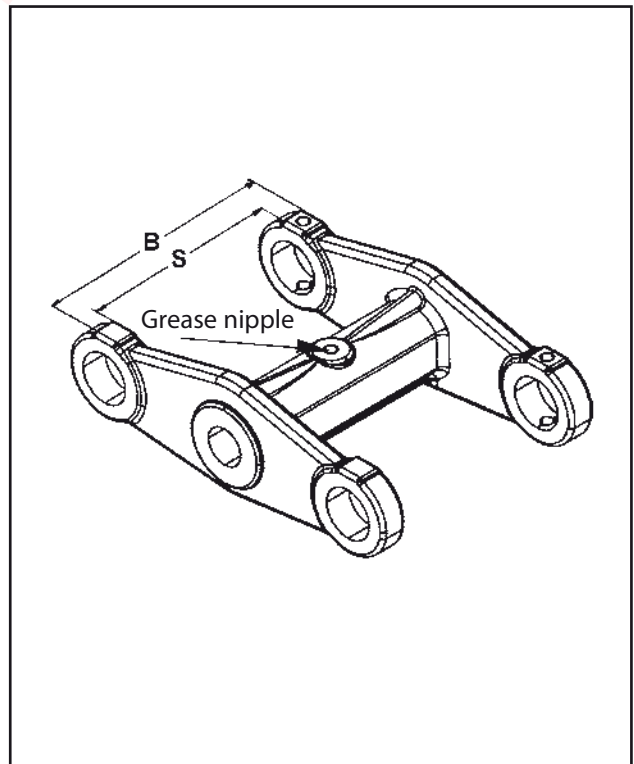
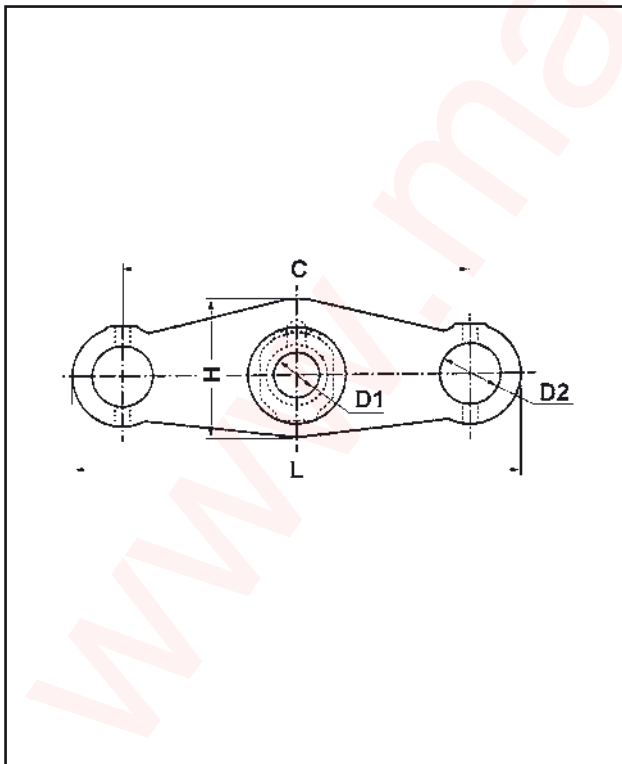

# TECHNISCHES DATENBLATT

## RADHALTERUNG

Gruppe  
**06-01-03-01**

Beispiel



Kundendaten

Maschinentyp: .....

Preis Anfrage

Serien-Nr. Maschine: .....

Bestellung

CODE: TY x L x B x H x D1 x D2 x C x D3 x TA x Pm x Pi x RH/LH x S x AT-BU x AFW x SMP

- TY..... Typ (siehe Bilder).  
L..... Max. Länge (mm).  
B..... Max. Breite (mm).  
H..... Max. Höhe (mm).  
D1 ..... Typ A: Bolzen oder Loch, Typ B: Loch zentral (siehe Bild).  
D2 ..... Durchmesser Loch Achse (mm).  
C..... Centermaß (mm).  
D3 ..... Durchmesser Kammer (flach oder konisch).  
TA ..... Gewindetyp (nicht immer).  
Pm..... Gewinde (metrisch).  
Pi ..... Gewinde (Daum).  
RH/LH..... Rechts oder links.  
S..... Abmessung siehe Bild (mm).  
AT-BU..... Buchsenzahl (wenn vorhanden).  
AFW ..... Verarbeitung:  
    *A = unbehandelt*  
    *B = farbbehandelt*  
    *C = elektrolytisch verzinkt silberfarbig*  
    *D = elektrolytisch verzinkt goldfarbig*  
    *E = galvanisiert*  
    *F = rostfrei*  
    *G = Aluminium*  
    *H = coldstore*  
SMP..... Schmiernippel: JA/NEIN.

# TYPEN

## Typ A

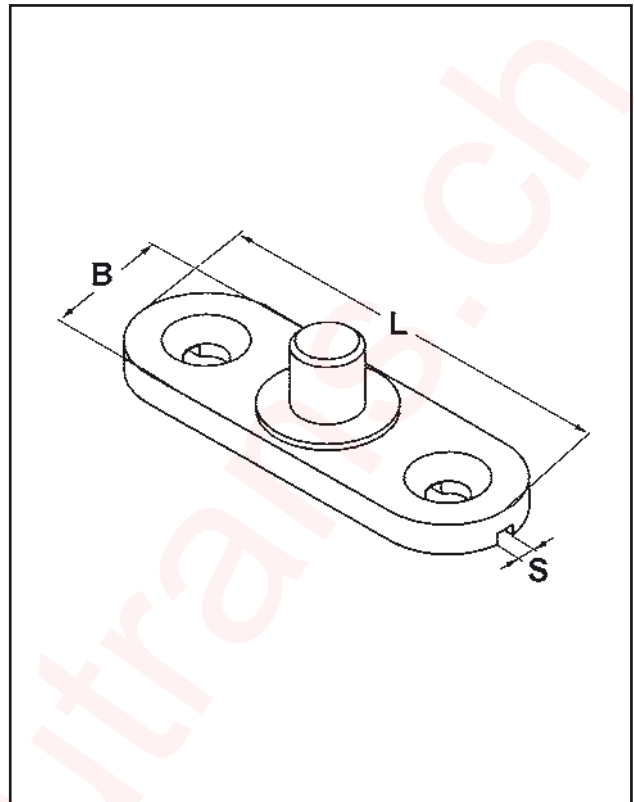
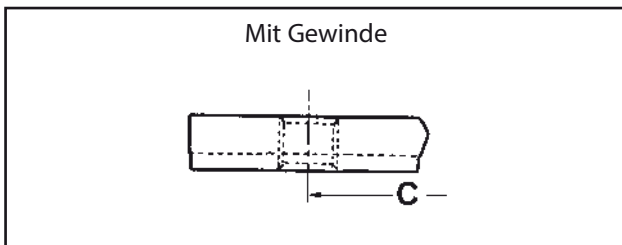
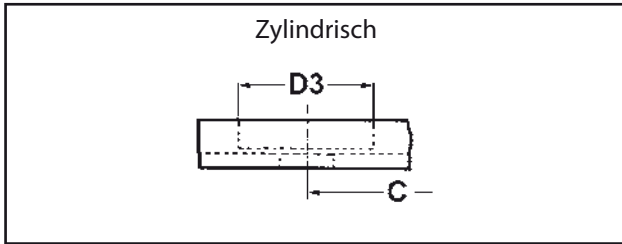
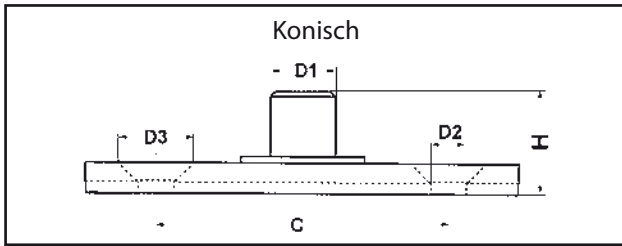

## Typ B

Radhalterung 1 Teil

