

FICHE TECHNIQUE

DISQUE DE FREIN

Groupe
13-01-06-00

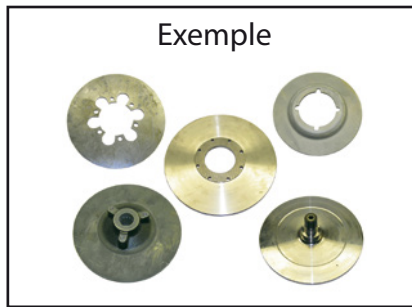

Données client

Type machine :

Demande de prix

No. série machine :

Commande

CODE : D1 x S x H x AT-GA x D2 x TA x Pm x Pi x TY-BV x D3 x D4 x B x AC

D1 Diamètre extérieur.

S Épaisseur du disque.

H Hauteur totale.

AT-GA Nombre total de trous de fixation.

D2 Diamètre des trous de fixation
(si plusieurs diamètres différents, prendre le plus gros).

TA Type de filetage.

Pm Pas métrique.

Pi Pas en pouce.

TY-BV Type de fixation.

D3 Diamètre intérieur, voir types de fixation.

D4 Diamètre intérieur, voir types de fixation.

B Largeur du clavetage, si présent.

AC Nombre de cannelures.

TYPES DE FIXATION CENTRALE

Type A
Trou rond simple

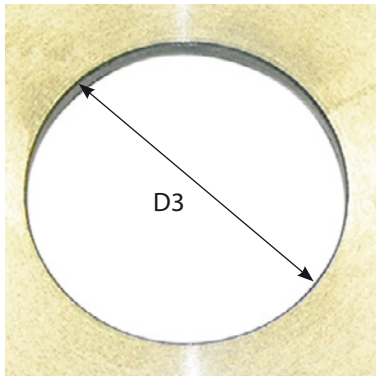

Type B
Cannelures internes

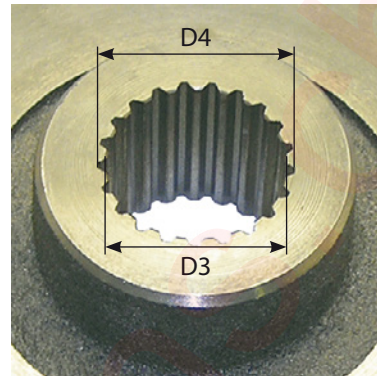

Type C
Trou rond avec rainure de clavetage

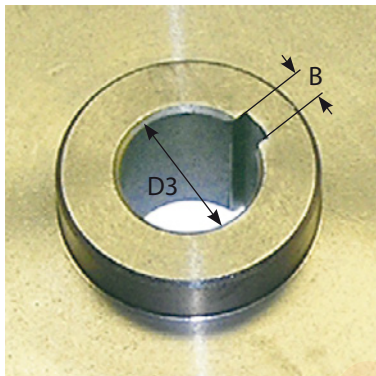

Type D
Cannelures externes

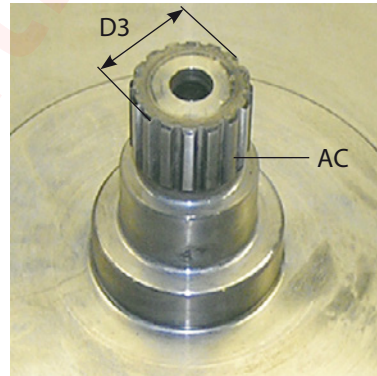

Type E
Trou rond avec encoches

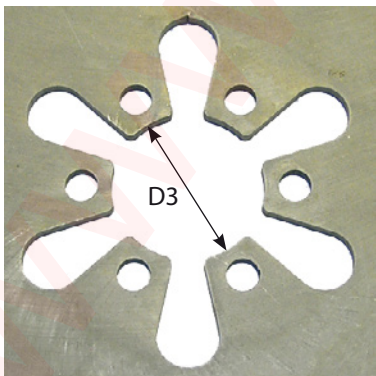

Type S
Autres types

TECHNICAL SHEET

BRAKE DISC

Group
13-01-06-00

Example



Customer details

Type machine:

Price inquiry

Serial n° machine:

Order

CODE: D1 x S x H x AT-GA x D2 x TA x Pm x Pi x TY-BV x D3 x D4 x B x AC

D1 Outer diameter.

S Thickness of disc.

H Total height.

AT-GA Number of mounting holes.

D2 Diameter of mounting holes
(if different diameters, please take biggest one).

TA Type of thread.

Pm Pitch (metric).

Pi Pitch (inch).

TY-BV Type of internal mounting point.

D3 Inner diameter, see types of internal mounting point.

D4 Inner diameter, see types of internal mounting point.

B Key width.

AC Number of splines.

INTERNAL TYPES

Type A
Normal round hole

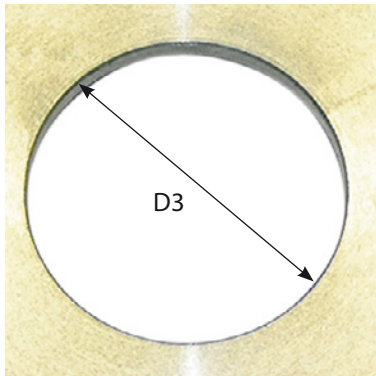

Type B
Internal splines

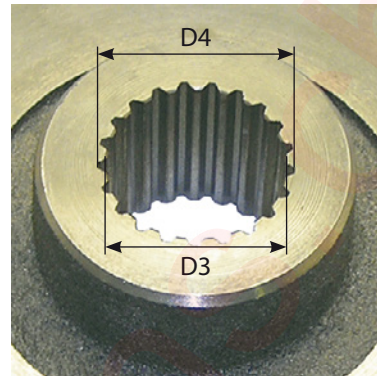

Type C
Round hole with splines

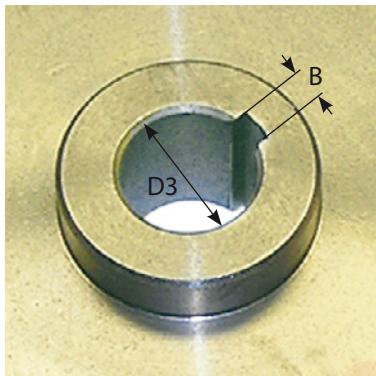

Type D
External splines

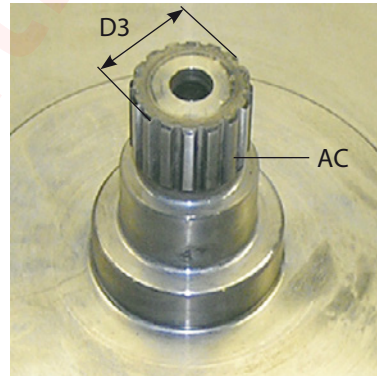

Type E
Round hole with notches

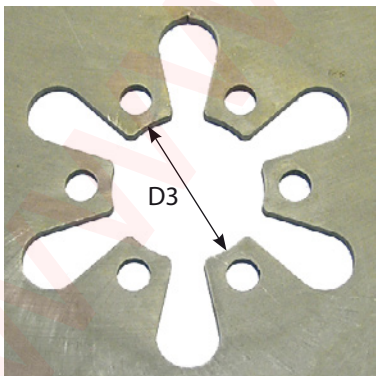

Type S
Other types

TECHNISCHES DATENBLATT

BREMSSCHEIBE

Gruppe
13-01-06-00



Kundendaten

Maschinentyp:

Preis-anfrage

Serien-Nr. Maschine:

Bestellung

CODE: D1 x S x H x AT-GA x D2 x TA x Pm x Pi x TY-BV x D3 x D4 x B x AC

D1 Außendurchmesser.

S Scheibendicke.

H Gesamthöhe.

AT-GA Gesamtanzahl Befestigungslöcher.

D2 Durchmesser Befestigungslöcher
(wenn unterschiedlicher Durchmesser, nehmen Sie den größten).

TA Gewindetyp Befestigungslöcher.

Pm Metrisch.

Pi Zoll.

TY-BV Typ Innenbefestigung.

D3 Innendurchmesser, siehe Typen Innenbefestigung.

D4 Innendurchmesser, siehe Typen Innenbefestigung.

B Breite des Keils, wenn vorhanden.

AC Anzahl von Kannelüren.

INNENTYPEN

Typ A
Normales rundes Loch

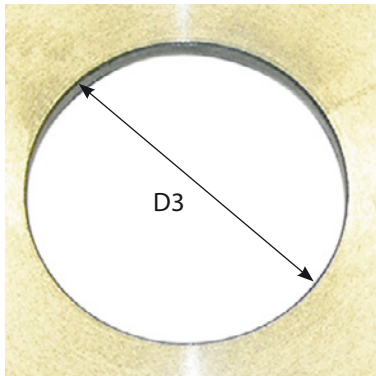

Typ B
Innenkannelüren

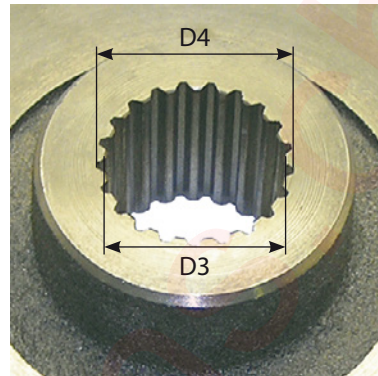

Typ C
Rundes Loch mit Keilnut

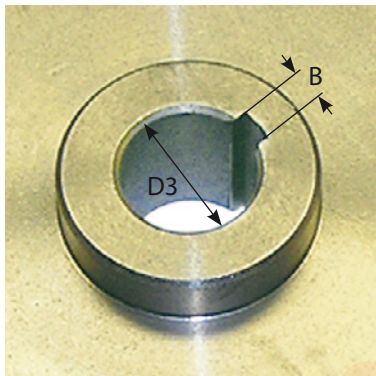

Typ D
Außenkannelüren

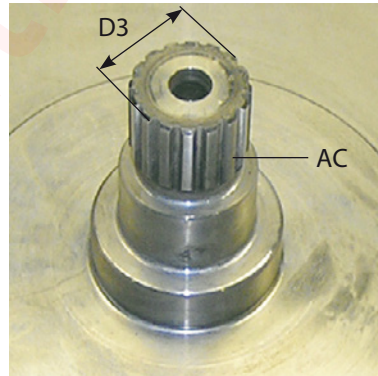

Typ E
Rundes Loch mit Kerbungen

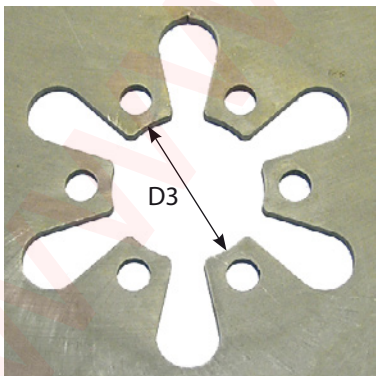

Typ S
Weitere Typen

AFMETINGEN/DIMENSIONS/ABMESSUNGEN

